

THIS DRAWING IS THE PROPERTY OF AD METRO. IT IS TO BE USED ONLY FOR THE PROJECT AND SHEET SPECIFICALLY IDENTIFIED HEREON. IT IS NOT TO BE REPRODUCED, COPIED, OR TRANSMITTED IN ANY FORM OR BY ANY MEANS, ELECTRONIC OR MECHANICAL, INCLUDING PHOTOCOPYING, RECORDING, OR BY ANY INFORMATION STORAGE AND RETRIEVAL SYSTEM, WITHOUT THE WRITTEN PERMISSION OF AD METRO.

REVISIONS			
LET	DESCRIPTION	DATE	BY
A	INITIAL RELEASE	12-10-12	DZ

FRONT VIEW
SCALE 1:1

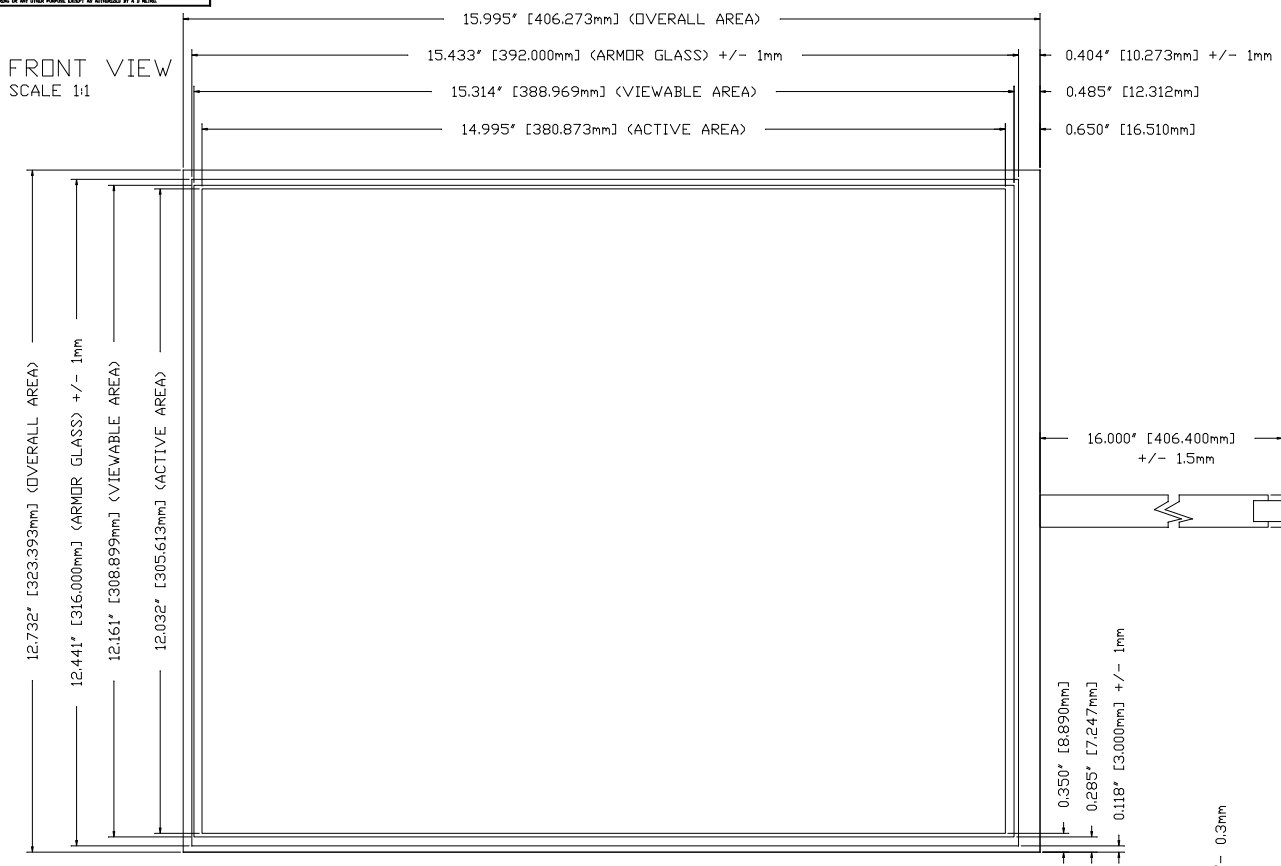

PIN	X1
1	LL
2	UL
3	SENSE
4	LR
5	UR

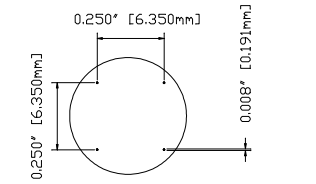

DETAIL A - DOT SPEC
SCALE 5:1

- NOTE:**
- SUBSTRATE: 3.18MM ITO GLASS.
 - ALL DIMENSIONS IN INCHES (MILLIMETERS).
 - SAFETY SEAM ON ALL EDGES.
 - CABLE: 5 PIN FFC TYPE.
 - CONNECTOR: AMP TYPE WITH 0.1' [2.54MM] CENTERS, NON LATCHING, PART NUMBER 487378-4.
 - TOUCH SCREEN TO BE ACTIVATED WITHIN ACTIVE AREA ONLY. AREA BETWEEN ACTIVE AND VIEWABLE AREAS MUST HAVE A SCREENED ON DIELECTRIC.
 - TOTAL SENSOR THICKNESS: 0.142' [3.600MM].
 - LINEARITY PATTERN: PEPPER.
 - ARMOR GLASS COATING: VACUUM DEPOSITED ANTI-REFLECTIVE WITH < 0.75% SPECULAR REFLECTION.

SIDE VIEW
NOT TO SCALE

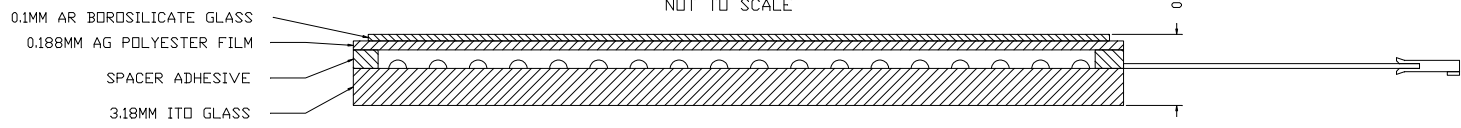

AD metro A D METRO - 1381 PARSIPPAN ST - OTTAWA, ONTARIO

AD19.0ULTRA

TOLERANCING UNLESS OTHERWISE SPECIFIED	DRAWN BY: DZ	PROJECT/ASSET NO. ---	SCALE
DATE: 12-10-12	PROJECT NAME	SHEET: 1	SHEET: 1
IS NOT SCALE DRAWING	PART NO. 3A99250-AR		